

# 4640 SERIES

## FEATURES

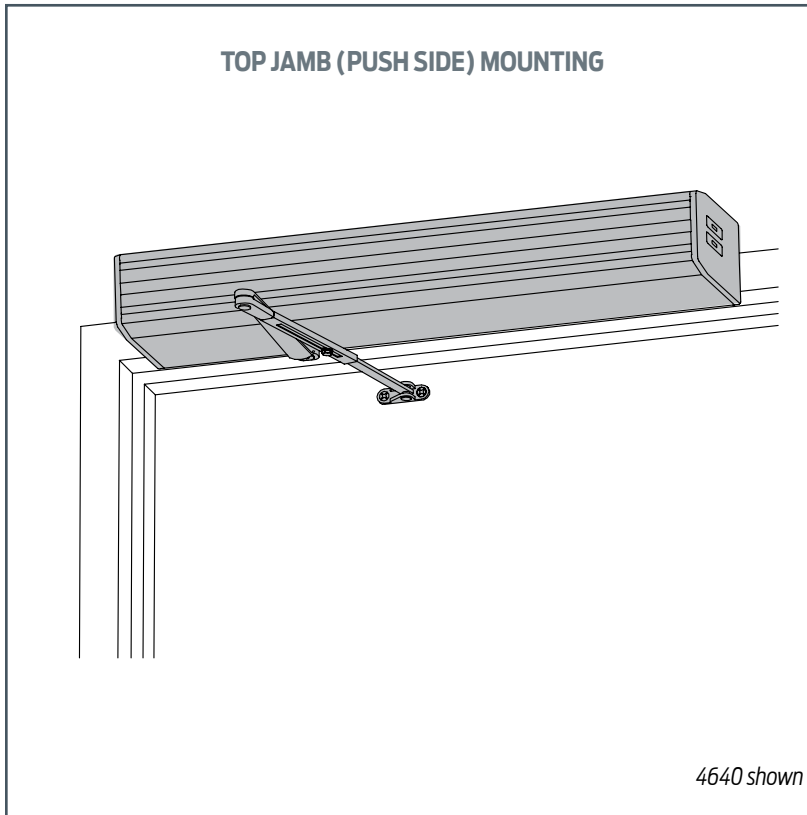

The 4640 AUTO EQUALIZER™ is LCN's SMART & RELIABLE electrically powered low-energy power operator. It provides easy access for people with disabilities, or the elderly. Designed primarily for manual opening applications that occasionally require automatic opening.

- NEW Digital Control Suite
- Utilizes a 4040 Heavy Duty Door Closer
- On-Board Diagnostics
- On-Board Power Supply
- Factory-Default Memory
- Includes "No Destruct" Drive System
- Guard Rails or Safety Mats not required

- Standard, top jamb (push side) mounted 4640 Series closer shipped with regular arm, metal cover, and wood and machine screw pack. Actuators available separately, see pages 122-137.
- Meets ADA, requirements (power mode).
- Non-sized cylinders for interior doors to 4' 6" and exterior doors to 3' 6".
- Non-handed for either right or left swinging door.
- 4640 has easily accessible switches to provide on/off and continuous hold open functions. 4640 with CS option provides concealed on/off power switch. Control module provides all timing and sequential door functions, electric strike controls and adjustments for opening speed and force.
- Standard or optional custom powder coated finish, end caps are black.
- Optional plated finish on cover, arm, and fasteners.

*The 4640 Series is UL and cUL listed with regular arm for self-closing doors and meets the provisions of ANSI Standards A117.1, A156.19, and the Americans with Disabilities Act.*

MOUNTING				FINISH		COVER		CYLINDER				*ARM FUNCTION						
TOP JAMB (PULL SIDE)	TOP JAMB (PUSH SIDE)	PARALLEL ARM	CONCEALED	POWDER COAT	PLATED	PLASTIC	METAL	NON-HANDED	NON-SIZED	ACCESSIBILITY*	POWER OPERATOR	HOLD-OPEN	DPS SWITCH	STANDARD (SINGLE)	REGULAR (DOUBLE)	EXTRA DUTY	CUSH-N-STOP	SPRING CUSH
○	●	○	○	●	●	○	●	●	○	●	●	○	○	○	○	○	○	○

● AVAILABLE  
○ NOT AVAILABLE

♿ Meets ADA requirements (power mode).  
\* See individual series for maximum manual opening.  
\*\* Switch provided for continuous hold open (4640 only).

# 4640 SERIES

## TOP JAMB (PUSH SIDE) MOUNTING

### MAXIMUM OPENING

Templating allows 90° power opening and 100° manual opening.

**Consult factory for all pivot mounted installations.**

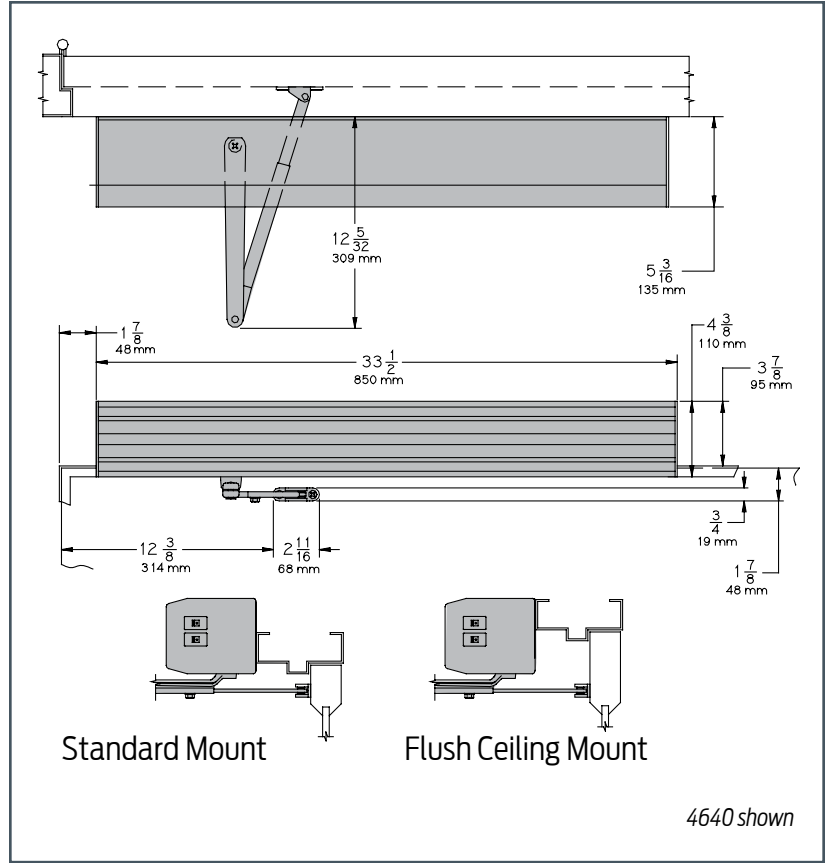

4640 shown

- **Butt Hinges** should not exceed 5" (127 mm) in width.
- **Auxiliary Stop** is recommended.
- **Reveal** of 4-1/2" (114 mm) allows up to 90° power opening and 100° manual opening. 8" (203 mm) allows up to 90° power opening and 100° manual opening with LONG ARM where standard rod and shoe is replaced with optional LONG ROD AND SHOE, 4640-79LR.
- **Head Frame** minimum 1-3/4" (44 mm). The standard mounting plate is also used to meet flush ceiling conditions.
- **Top Rail** minimum 1-3/4" (44 mm).  
Flush ceiling installation requires 3-3/4" (95 mm) minimum.
- **Opening Time and Force** are variable by adjustments to the electronic control module located on the operator assembly. Maximum hold open time adjustable up to approximately five minutes.
- **System Diagram** See "AUTOMATIC OPERATORS" section page 36 for typical system wiring and pages 37-38 for electrical data.

### Options

- Long arm.

### Special Templates

Customized installation templates or products may be available to solve unusual applications. Contact LCN Product Support for assistance.

# 4640 SERIES

## CYLINDERS

### CYLINDER ONLY, 4642-3971

Standard, non-handed, cast iron cylinder.

### CYLINDER ASSEMBLY, 4642-3071

Standard, non-handed, cast iron cylinder and mounting plate.  
Includes; 4640-3454 Motor Clutch, 4640-3180 I/O Board Assembly and 4640-3462 Controller.

### CYLINDER ASSEMBLY, 4642-3071CS

Standard, non-handed, cast iron cylinder and mounting plate.  
Includes; 4640-3454 Motor Clutch, 4640-3180 I/O Board Assembly and 4640-3462 Controller. Same as a 4640-3071 assembly except on/off switch is concealed in endcap and no hold open switch is included. (Separate key switches suggested).

## COVERS

### COVER, 4640-72MC

Standard, non-handed metal cover.

## ARMS

### REGULAR ARM, 4640-3077

Non-handed arm.

### LONG ARM, 4640-3077L

Arm includes LONG ROD AND SHOE, 4640-79LR for deep reveals.

### ROD & SHOE, 4640-79

Rod for use with regular arm.

### LONG ROD & SHOE, 4640-79LR

Long rod used for long arm with deep reveals.

3971

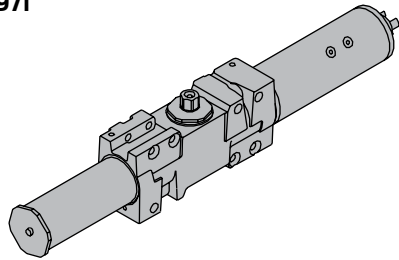

3071

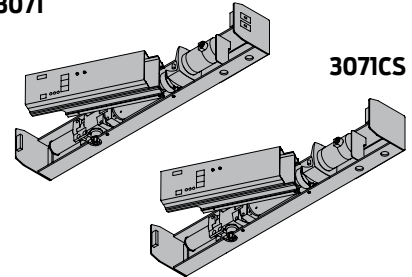

72MC

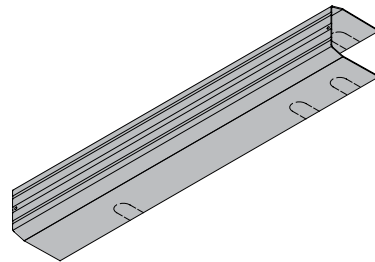

3077  
3077L

79LR  
79

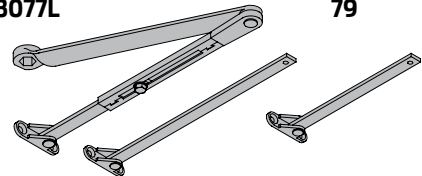

# 4640 SERIES

## INSTALLATION ACCESSORIES

### SWITCH END CAP, 4640-334

End cap (black powder finish coat only) with cut outs for installing on/off and hold open switches.

### BLANK END CAP, 4640-334-2

Black power coat only.

### SWITCH END CAP, 4640-334CS

End cap and switch (black powder coat only) for concealed switch option.

### ON/OFF SWITCH ASSEMBLY, 4640-3179-1

Black rocker switch. Plugs into high voltage PC board.

### HOLD-OPEN SWITCH ASSEMBLY, 4640-3179-2

Black rocker switch. Field wired to low voltage PC board.

### PC BOARD ASSEMBLY, 4640-3180

High and low voltage PC boards connected to mounting bracket.

### MOTOR/CLUTCH ASSEMBLY, 4640-3454

A geared assembly in an LCN power operator that incorporates a "no destruct" feature.

### CONTROL BOX ASSEMBLY, 4640-3462

Digital controller with built-in 12/24 VDC power supply. Programming and timing functions are adjusted on controller.

### AC POWER CABLE, 4640-3498-2

2 wire cable to connect 120 VAC from PC board assembly to controller.

### RIBBON CABLE CONNECTOR, 4640-3498-1

16 wire ribbon cable connecting 1-24 pin terminal connectors to controller.

334  
334-2  
334CS

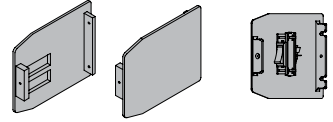

3179-1  
3179-2

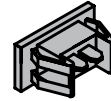

3180

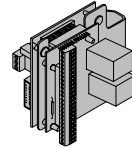

3454

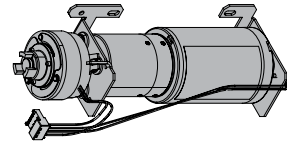

3462

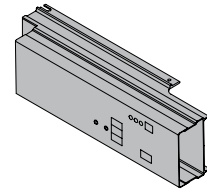

3498-2

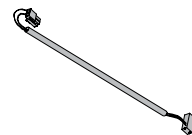

3498-1

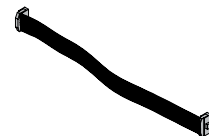

# 4640 SERIES

## TABLE OF SIZES

Non-sized 4640 series cylinder is adjustable from size 2 through size 5 and is shipped set to size 3. Closing power of 4640 Series closers may be increased 50%.

### EXTERIOR (and VESTIBULE) DOOR WIDTH

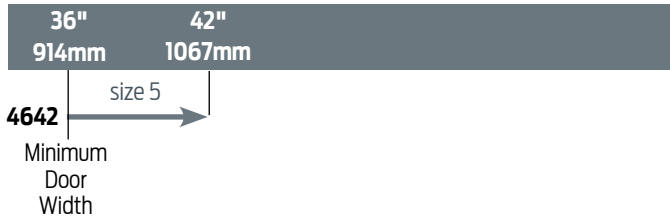

### INTERIOR DOOR WIDTH

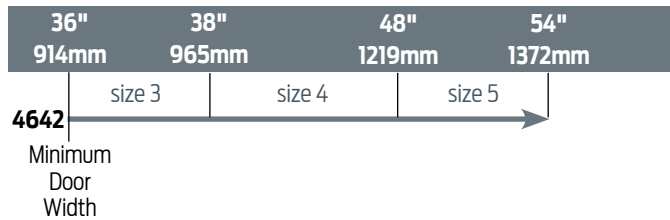

→ Indicates recommended range of door width for closer size.

NOTE: Minimum door width 36" (914 mm).

## HOW-TO-ORDER 4640 SERIES CLOSERS

### 1. SPECIFY FINISH

- Standard Powder Coat \_\_\_\_\_  
Aluminum, Dark Bronze, Statuary,  
Light Bronze, Black, Brass.

### Closer will be shipped with:

- STANDARD CYLINDER,
- STANDARD METAL COVER,
- REGULAR ARM,
- WOOD and MACHINE SCREW PACK,  
*unless options listed below are selected.*

## CLOSER OPTIONS

### CYLINDER ASSEMBLY

- CS (concealed on/off switch)  
(separate key switches suggested)

### FINISH

- Custom Powder Coat (RAL) \_\_\_\_\_
- Plated Finish, US \_\_\_\_\_

### ARM

- Long (LONG)

### SCREW PACK

- TB\*, Wood & Machine Screw (TBWMS)
- TORX Machine Screw (TORX)
- TB\* & TORX Machine Screw (TBTRX)  
\*Specify door thickness if other than 1-3/4".

### SPECIAL TEMPLATE

- ST-\_\_\_\_\_